



# Inspiring hope through design

Compassionate and supportive family-centred care  
Promoting holistic healing

The new MRI Scanner Unit  
Royal Belfast Hospital for Sick Children  
Northern Ireland

## Belfast Health and Social Care Trust

### Previously:

152 children under 14 waiting 6 months for an MRI scan  
0 children having MRI treatment in a child-friendly environment

### Today:

500 children + have been scanned in a dedicated family-friendly children's centre

“ There is evidence the environment is contributing to a reduction in the number of children requiring general anaesthesia which is very encouraging. ”

Belfast Health and Social Care Trust

“ The centre exudes a feeling of calm which is so important when all of the patients are children. ”

Superintendent Radiographer, RBHSC

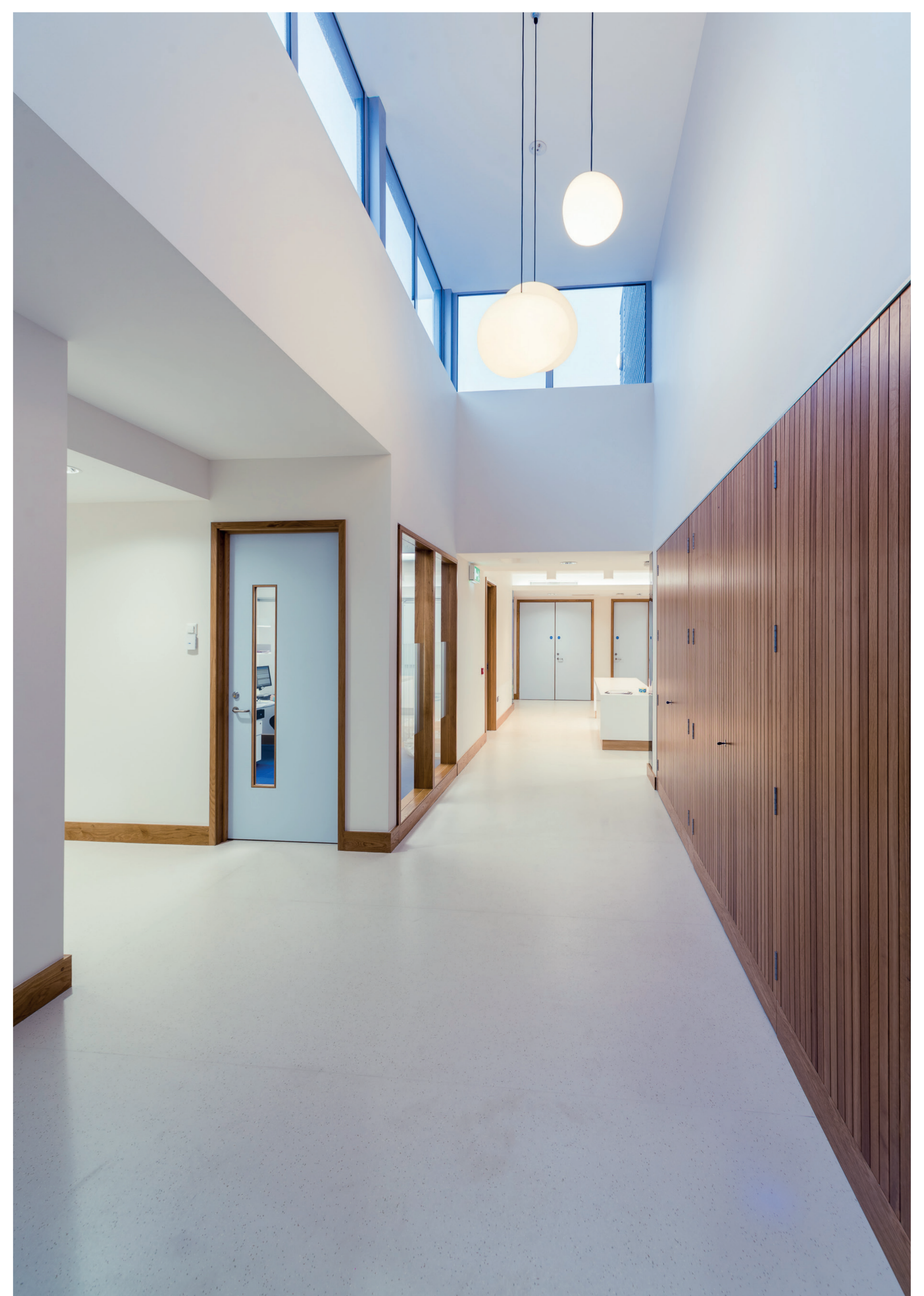

### Services:

Architecture, structural and civil engineering,  
medical planning, CDMC