

Flexibility and Adaptability: Needs, types and value in future healthcare design

FLEX

A STUDY OF FLEXIBILITY IN OUTPATIENT SETTINGS
A CADRE Study by HKS and Steelcase

Creating Hospitals for Continual Change’ initiative.

The healthcare landscape is changing dramatically with health systems increasingly pressured to respond appropriately to challenges such as catastrophic events, contagious epidemics, shifts in care settings and evolving technology, which all impact health delivery significantly and the way we need to design hospitals for the future.

Our initiative challenges how we look at these drivers’ impact for designing smarter hospitals. Instead of being reactive and preventative in the way we design, looking to the future, there is the ability to be much more predictive in what we are designing for. People are accessing health in different ways than before, with increased integration with health and lifestyle from one’s own home. If we harness this information in an intelligent way, the way we design and use our hospitals will change - operationally, spatially and economically.

The cross-typology matrix shows the opportunity to flex within the health typology across the different acuity levels, as well as the opportunity to be flexible across a change of typologies. In order to do this, a versatile building framework has been developed to support all typologies; to allow user modifications on any scale, yet to have the ability to be converted, expanded and contracted as demands require. Together with technology, A.I. and data analysis, we can start to predict what we really need spatially, rather than be reactive – the digital twin.

With this philosophy and learning from other industries and sectors, we reviewed the traditional acute hospital and how its spatial needs will change through time – a healthcare system of Anchors and Tenants across a short term, medium and long term view.

Design is a drop in the ocean compared to the actual running cost of the overall hospital estate and with all these pressures on the health systems, the quality of healthcare outcomes, such as the patient and staff experience, their safety and care can be significantly impacted.

We won’t get better healthcare outcomes if we stick to business as usual.

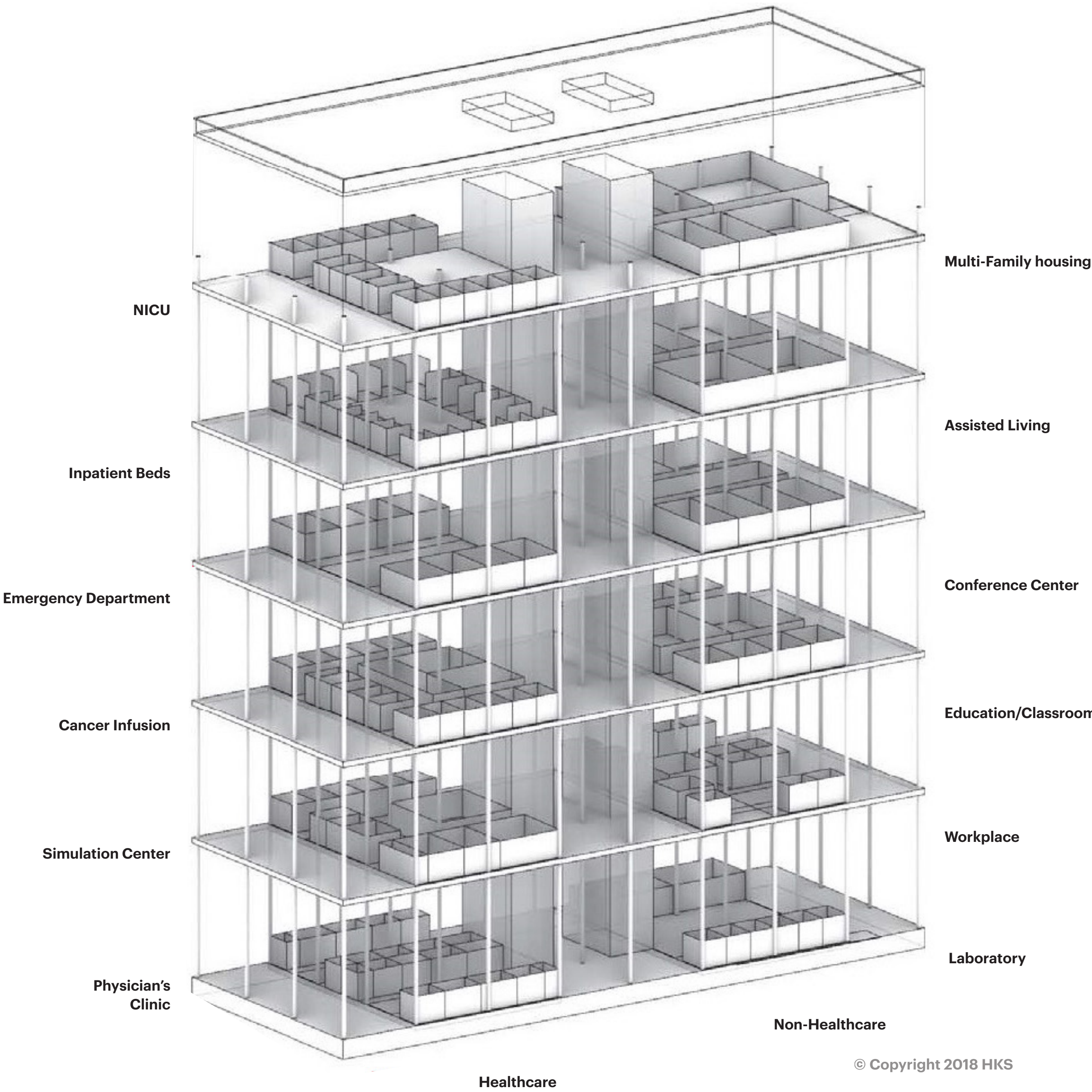

Ongoing RESEARCH : Design for an ever changing present

